

DWG BY: LMARTINEZ 2934

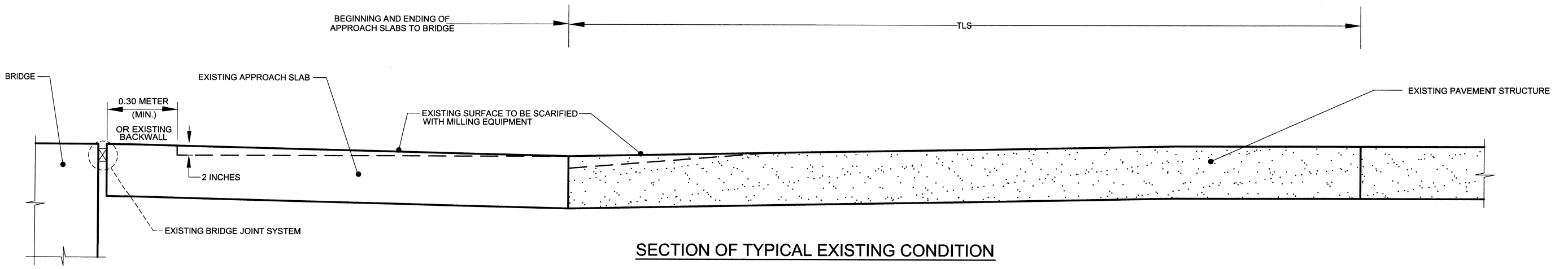

SECTION OF TYPICAL EXISTING CONDITION

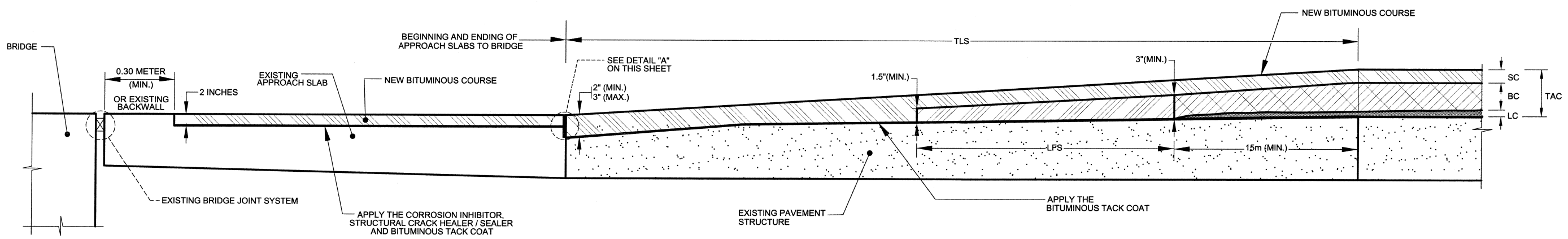

SECTION OF TYPICAL NEW BITUMINOUS COURSES

LEGEND

- BITUMINOUS LEVELING COURSE (HOT PLANT-MIX BITUMINOUS L-2(75))
- BITUMINOUS BASE COURSE (HOT PLANT-MIX BITUMINOUS B-1(75) OR SPB)
- BITUMINOUS SURFACE COURSE (FIRST LAYER) (HOT PLANT-MIX BITUMINOUS S-1(75) OR SPS)
- BITUMINOUS SURFACE COURSE (SECOND LAYER) (HOT PLANT-MIX BITUMINOUS S-1(75) OR SPS)

TRANSITION TO BITUMINOUS PAVEMENTS AND STRUCTURES TYPE 5

TAC (INCHES)	MIN. COURSE THICKNESS			MIN. TRANSITION LENGTHS			MIN. LENGTH LFS (METERS)	MILLING LENGTH (METERS)
	LC (INCHES)	BC (INCHES)	SC (INCHES)	TLL (METERS)	TLB (METERS)	TLS (METERS)		
2	NA	NA	2	0	0	45	NA	10
3	1	NA	2	15	0	55	NA	10
4	2	NA	2	25	0	65	NA	15
5	NA	3	2	0	35	75	30	15
6	NA	4	2	0	45	85	35	20
7	1	4	2	15	55	95	40	20

NOTES:

1. THE GENERAL NOTES, PROCEDURES AND DETAILS FOR TRANSITION TO BITUMINOUS PAVEMENTS AND STRUCTURES TYPE 5 ARE SHOWN ON SHEET MBPD-1.
2. THE PLACING SEQUENCE OF BITUMINOUS COURSES ARE SHOWN ON SHEET MBPD-8.

TAC = THICKNESS OF ALL BITUMINOUS COURSES
 LC = THICKNESS OF BITUMINOUS LEVELING COURSE
 BC = THICKNESS OF BITUMINOUS BASE COURSE
 SC = THICKNESS OF BITUMINOUS SURFACE COURSE
 TLL = TRANSITION LENGTH OF BITUMINOUS LEVELING COURSE
 TLB = TRANSITION LENGTH OF BITUMINOUS BASE COURSE
 TLS = TRANSITION LENGTH OF BITUMINOUS SURFACE COURSE
 LFS = LENGTH OF FIRST LAYER OF BITUMINOUS SURFACE COURSE

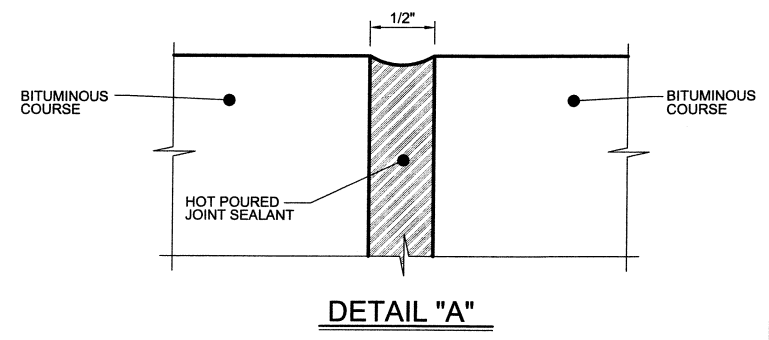

DETAIL "A"



COMMONWEALTH OF PUERTO RICO
 DEPARTMENT OF TRANSPORTATION AND PUBLIC WORKS
 HIGHWAY AND TRANSPORTATION AUTHORITY

STANDARD DRAWING APPROVED BY:

 30/12/10
 ASSISTANT EXECUTIVE DIRECTOR FOR INFRASTRUCTURE

MISCELLANEOUS BITUMINOUS PAVEMENT DETAILS
 DETAILS FOR TRANSITION TO BITUMINOUS PAVEMENTS AND STRUCTURES TYPE 5

MBPD-07
 MAY 2010

ENGINEERING STANDARDS OFFICE
ENGINEERING SERVICES AREA