

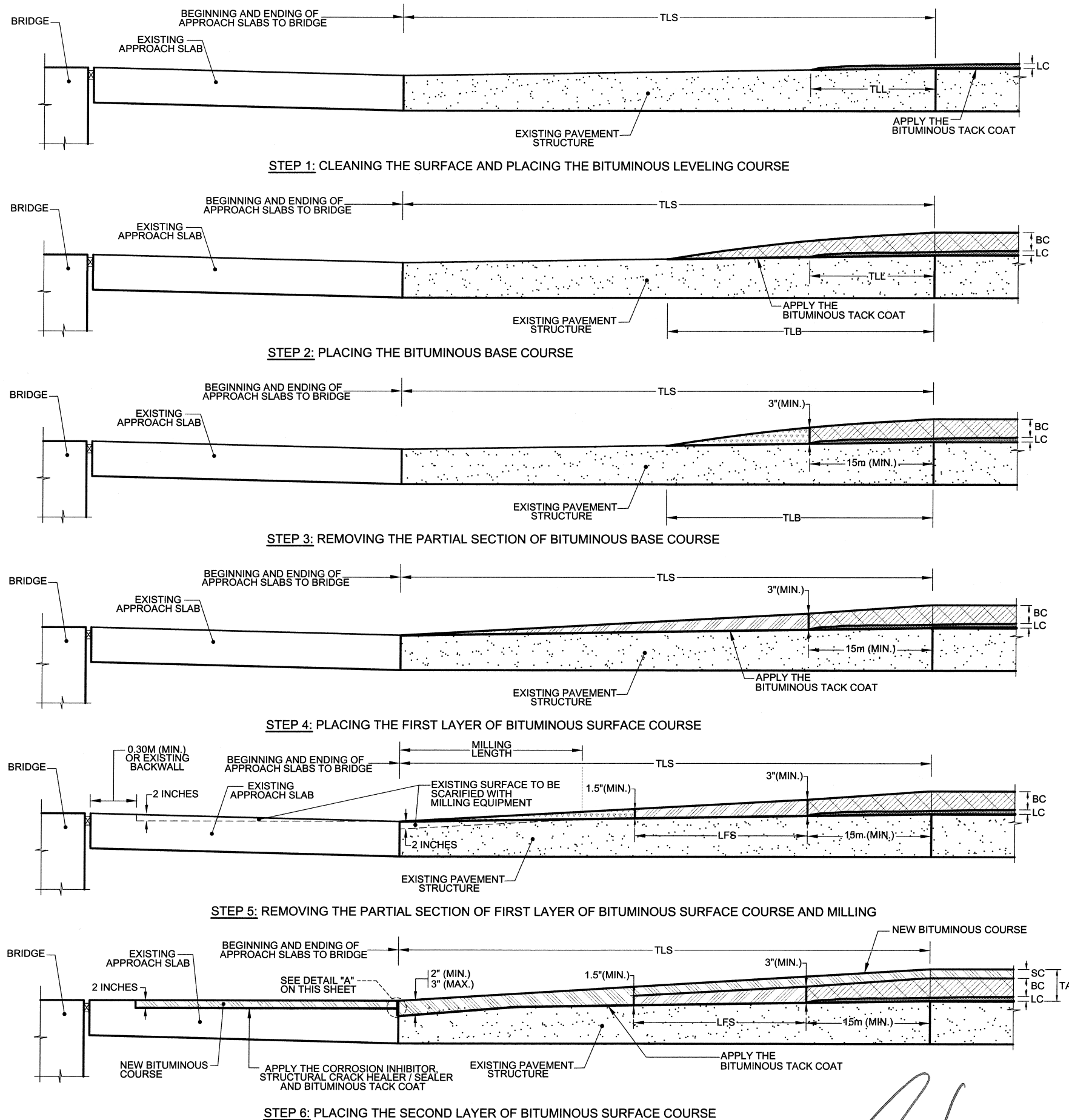



BY	REVISION
DATE	REVISION
BY	REVISION
DATE	REVISION
BY	REVISION
DATE	REVISION
BY	REVISION
DATE	REVISION

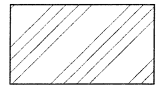
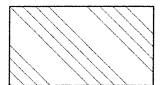

LEGEND

-  BITUMINOUS LEVELING COURSE (HOT PLANT-MIX BITUMINOUS L-2(75))
-  BITUMINOUS BASE COURSE (HOT PLANT-MIX BITUMINOUS B-1(75) OR SPB)
-  BITUMINOUS SURFACE COURSE (FIRST LAYER) (HOT PLANT-MIX BITUMINOUS S-1(75) OR SPS)
-  BITUMINOUS SURFACE COURSE (SECOND LAYER) (HOT PLANT-MIX BITUMINOUS S-1(75) OR SPS)
-  SECTION TO BE REMOVED BEFORE PLACING THE BITUMINOUS COURSE

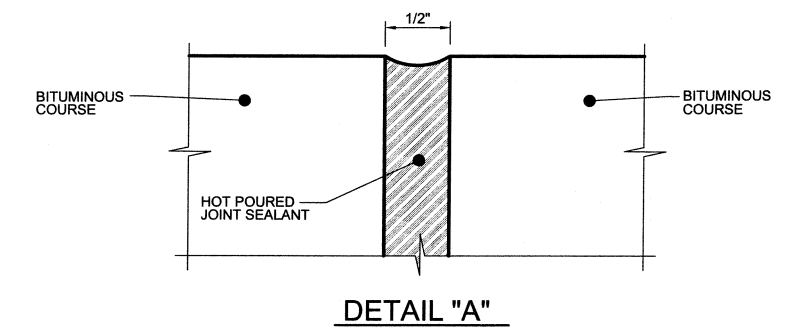

NOTE:

1. THE DEFINITIONS OF DIMENSIONS OF THE DISTANCES FOR TRANSITION TO BITUMINOUS PAVEMENTS AND STRUCTURES TYPE 5 ARE SHOWN ON SHEET MCPD-7.



COMMONWEALTH OF PUERTO RICO
DEPARTMENT OF TRANSPORTATION AND PUBLIC WORKS
HIGHWAY AND TRANSPORTATION AUTHORITY

STANDARD DRAWING APPROVED BY: *[Signature]*
DATE: 30/11/10
ASSISTANT EXECUTIVE DIRECTOR FOR INFRASTRUCTURE

MISCELLANEOUS BITUMINOUS PAVEMENT DETAILS
PLACING SEQUENCE OF BITUMINOUS COURSE TYPE 5

MBPD-08
MAY 2010