

BY	REVISION	DATE
BY	REVISION	DATE
BY	REVISION	DATE
BY	REVISION	DATE
BY	REVISION	DATE
BY	REVISION	DATE
BY	REVISION	DATE
BY	REVISION	DATE
BY	REVISION	DATE
BY	REVISION	DATE

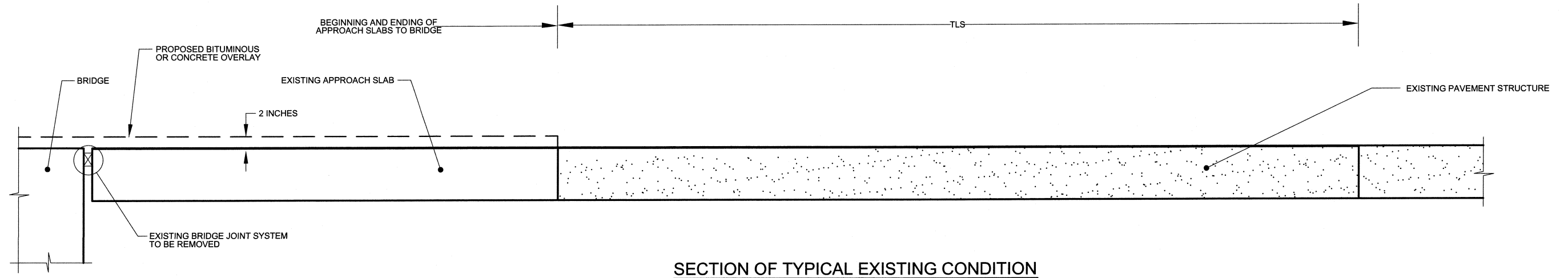

SECTION OF TYPICAL EXISTING CONDITION

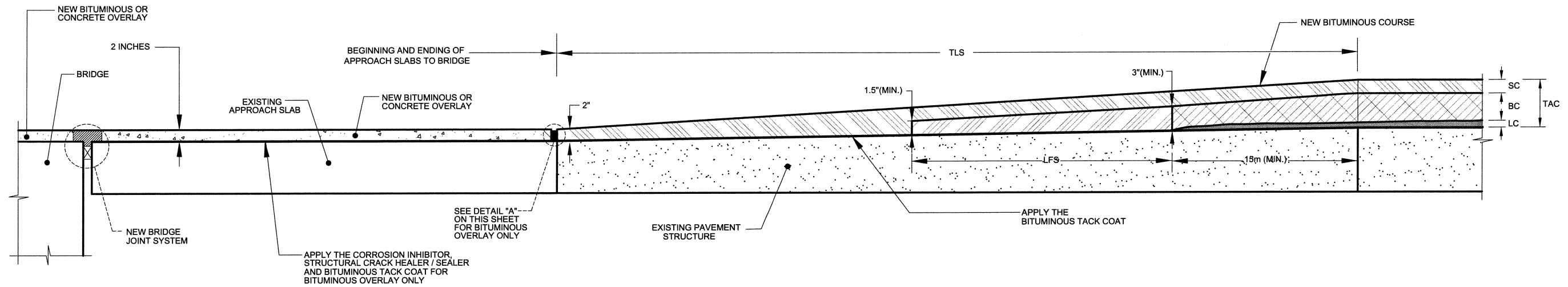

SECTION OF TYPICAL NEW BITUMINOUS COURSE AND OVERLAY

LEGEND

- BITUMINOUS LEVELING COURSE (HOT PLANT-MIX BITUMINOUS L-2(75))
- BITUMINOUS BASE COURSE (HOT PLANT-MIX BITUMINOUS B-1(75) OR SPB)
- BITUMINOUS SURFACE COURSE (FIRST LAYER) (HOT PLANT-MIX BITUMINOUS S-1(75) OR SPS)
- BITUMINOUS SURFACE COURSE (SECOND LAYER) (HOT PLANT-MIX BITUMINOUS S-1(75) OR SPS)

NOTES:

1. THE GENERAL NOTES, PROCEDURES AND DETAILS FOR TRANSITION TO BITUMINOUS PAVEMENTS AND STRUCTURES TYPE 6 ARE SHOWN ON SHEET MBPD-1.
2. THE PLACING SEQUENCES OF BITUMINOUS COURSES ARE SHOWN ON SHEET MBPD-10.

TRANSITION TO BITUMINOUS PAVEMENTS AND STRUCTURES SLAB TYPE 6

TAC (INCHES)	MIN. COURSE THICKNESS			MIN. TRANSITION LENGTHS			MIN. LENGTH (METERS)
	LC (INCHES)	BC (INCHES)	SC (INCHES)	TLL (METERS)	TLB (METERS)	TLS (METERS)	
2	NA	NA	2	0	0	25	NA
3	1	NA	2	15	0	35	NA
4	2	NA	2	25	0	45	NA
5	NA	3	2	0	35	55	20
6	NA	4	2	0	45	65	25
7	1	4	2	15	55	75	30

- TAC = THICKNESS OF ALL BITUMINOUS COURSES
- LC = THICKNESS OF BITUMINOUS LEVELING COURSE
- BC = THICKNESS OF BITUMINOUS BASE COURSE
- SC = THICKNESS OF BITUMINOUS SURFACE COURSE
- TLL = TRANSITION LENGTH OF BITUMINOUS LEVELING COURSE
- TLB = TRANSITION LENGTH OF BITUMINOUS BASE COURSE
- TLS = TRANSITION LENGTH OF BITUMINOUS SURFACE COURSE
- LFS = LENGTH OF FIRST LAYER OF BITUMINOUS SURFACE COURSE

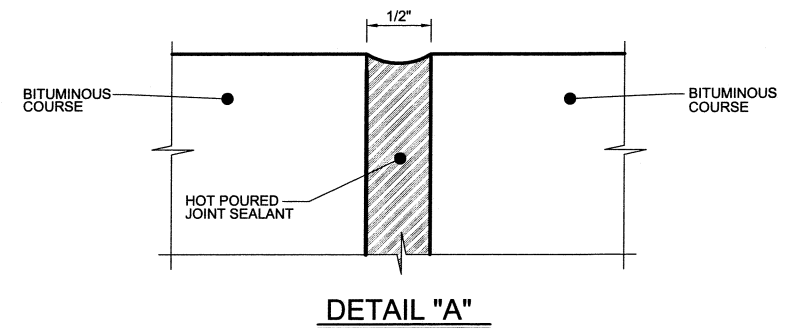

COMMONWEALTH OF PUERTO RICO
DEPARTMENT OF TRANSPORTATION AND PUBLIC WORKS
HIGHWAY AND TRANSPORTATION AUTHORITY

STANDARD DRAWING APPROVED BY:

ASSISTANT EXECUTIVE DIRECTOR
FOR INFRASTRUCTURE

30/IV/10

MISCELLANEOUS BITUMINOUS
PAVEMENT DETAILS
DETAILS FOR TRANSITION TO BITUMINOUS
PAVEMENTS AND STRUCTURES TYPE 6

MBPD-09

MAY 2010