

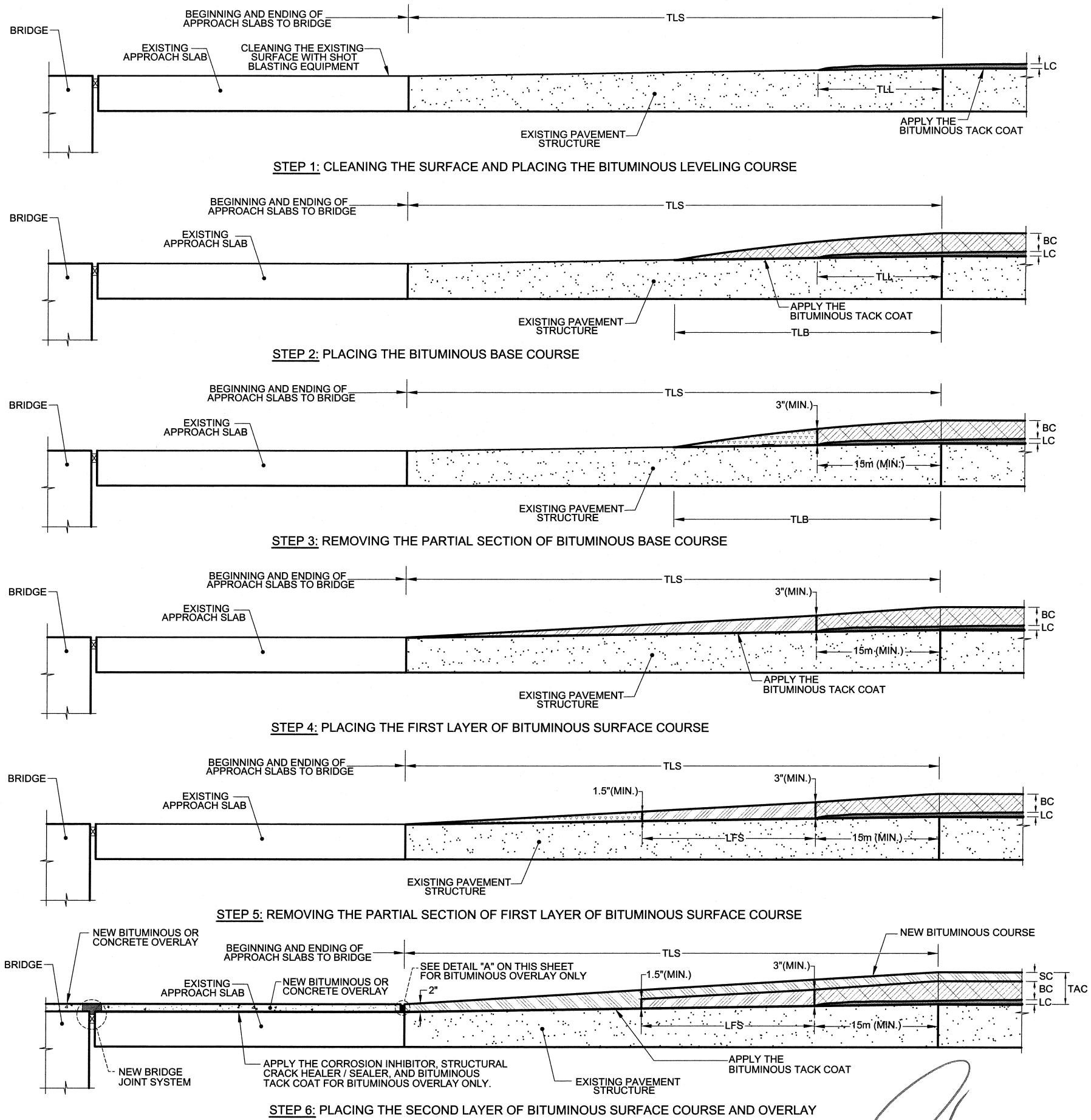



DWG BY: LMARTINEZ 2934

BY	
REVISION	
DATE	
BY	
REVISION	
DATE	
BY	
REVISION	
DATE	
BY	
REVISION	
DATE	

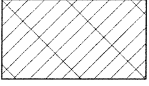
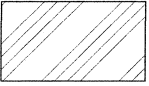

LEGEND

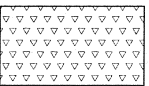
-  BITUMINOUS LEVELING COURSE (HOT PLANT-MIX BITUMINOUS L-2(75))
-  BITUMINOUS BASE COURSE (HOT PLANT-MIX BITUMINOUS B-1(75) OR SPB)
-  BITUMINOUS SURFACE COURSE (FIRST LAYER) (HOT PLANT-MIX BITUMINOUS S-1(75) OR SPS)
-  BITUMINOUS SURFACE COURSE (SECOND LAYER) (HOT PLANT-MIX BITUMINOUS S-1(75) OR SPS)
-  SECTION TO BE REMOVED BEFORE PLACING THE BITUMINOUS COURSE

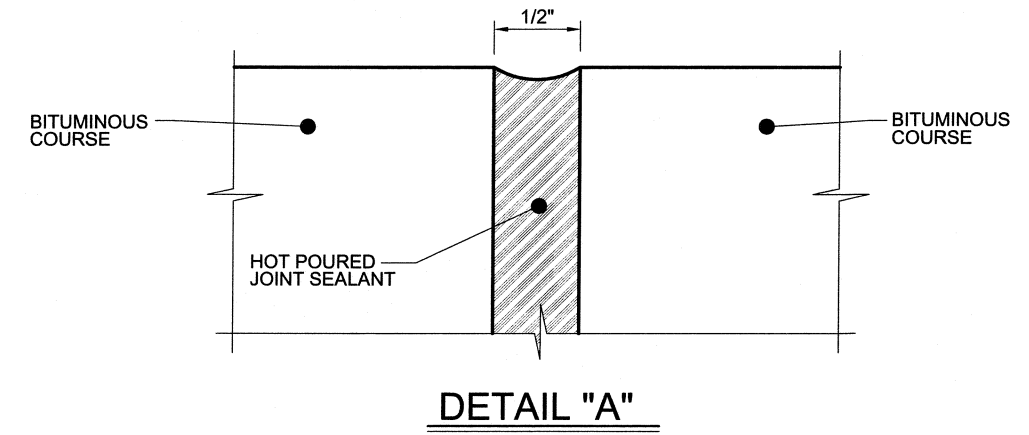

NOTE:

1. THE DEFINITIONS OF DIMENSIONS OF THE DISTANCES FOR TRANSITION TO BITUMINOUS PAVEMENTS AND STRUCTURES TYPE 6 ARE SHOWN ON SHEET MCPD-9.



COMMONWEALTH OF PUERTO RICO
DEPARTMENT OF TRANSPORTATION AND PUBLIC WORKS
HIGHWAY AND TRANSPORTATION AUTHORITY

STANDARD DRAWING APPROVED BY:

[Signature]
30/10/10
ASSISTANT EXECUTIVE DIRECTOR
FOR INFRASTRUCTURE

MISCELLANEOUS BITUMINOUS
PAVEMENT DETAILS
PLACING SEQUENCE OF
BITUMINOUS COURSE TYPE 6

MBPD-10

MAY 2010

ENGINEERING SERVICES AREA ENGINEERING STANDARDS OFFICE