

BY	
REVISION	
DATE	
BY	
REVISION	
DATE	
BY	
REVISION	
DATE	
BY	
REVISION	
DATE	

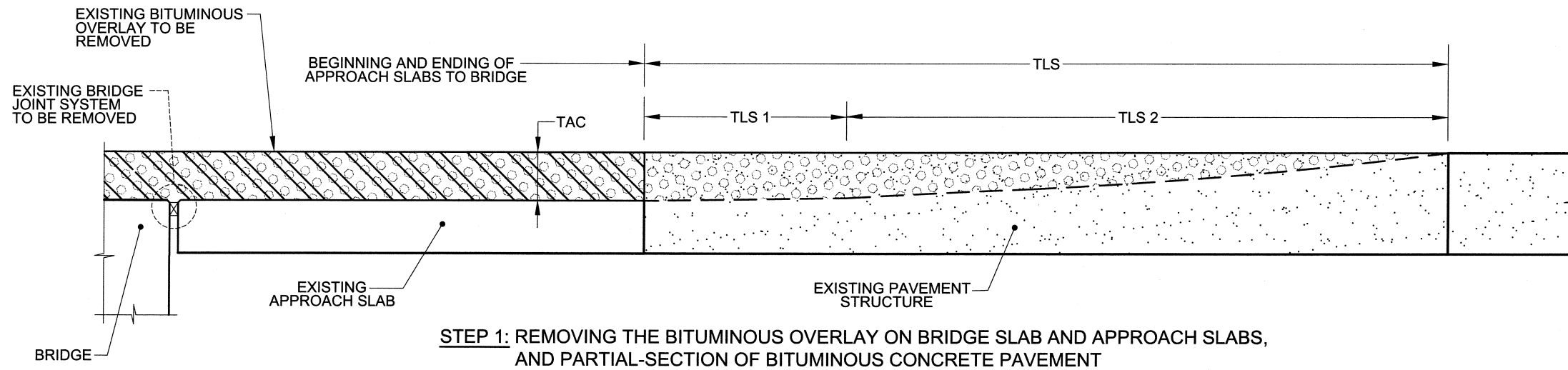

LEGEND

	EXISTING BITUMINOUS COURSE
	EXISTING BITUMINOUS OVERLAY
	SECTION TO BE REMOVED
	NEW BITUMINOUS SURFACE COURSE (HOT PLANT-MIX BITUMINOUS S-1(75) OR SPS)

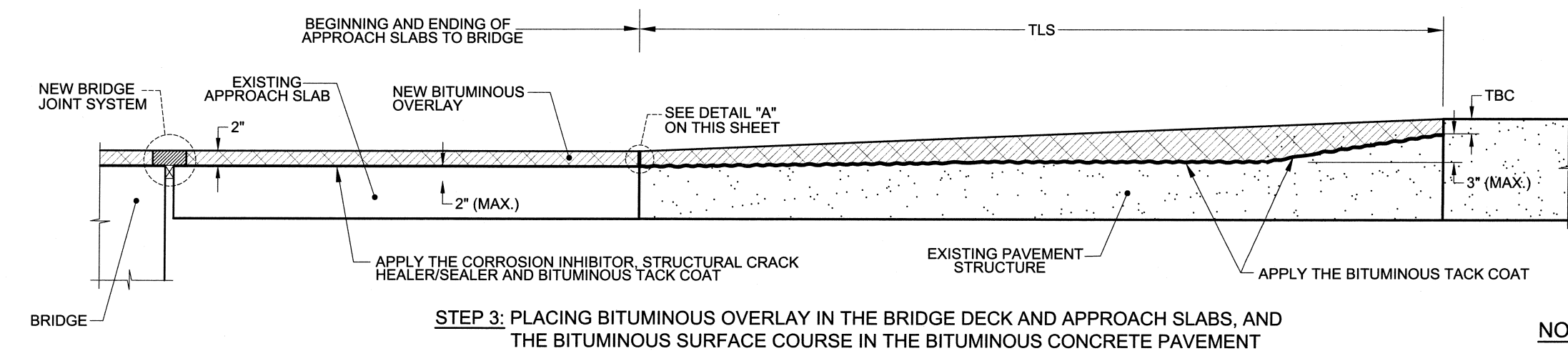
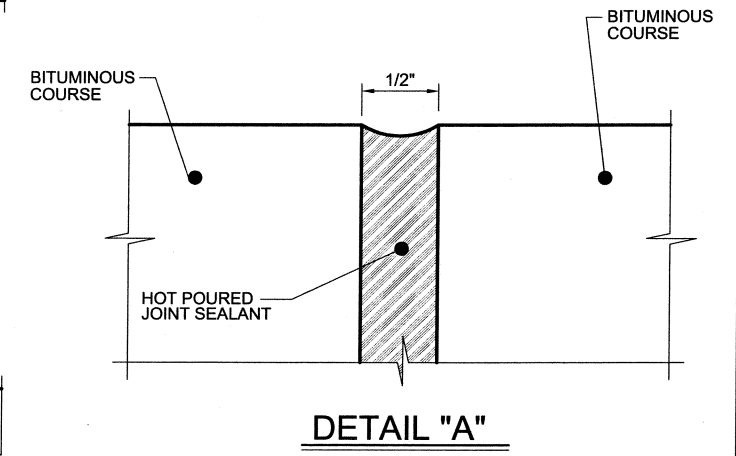
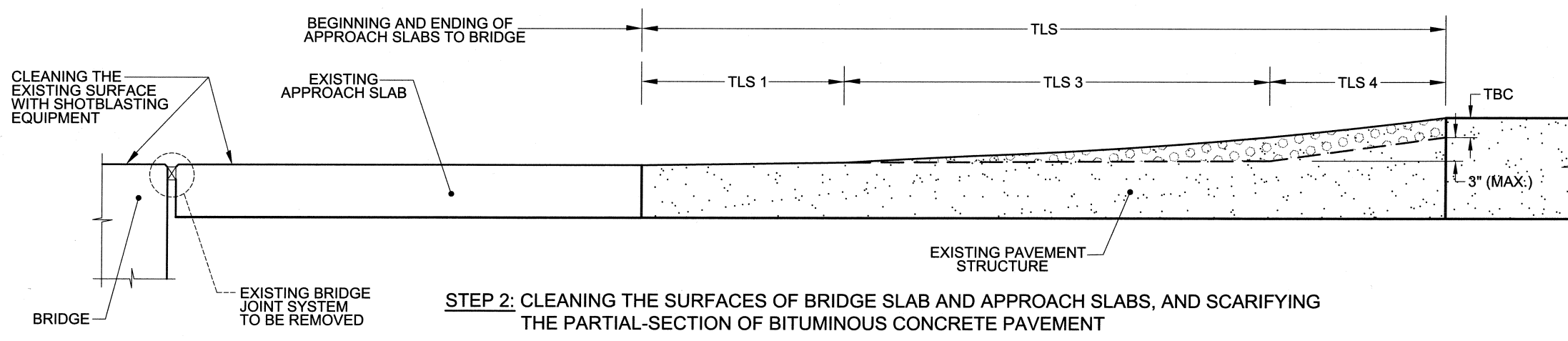

NOTE:

1. THE DEFINITIONS OF DIMENSIONS OF THE DISTANCES FOR TRANSITION TO BITUMINOUS PAVEMENTS AND STRUCTURES TYPE 8 ARE SHOWN ON SHEET MCPD-13.



COMMONWEALTH OF PUERTO RICO
DEPARTMENT OF TRANSPORTATION AND PUBLIC WORKS
HIGHWAY AND TRANSPORTATION AUTHORITY

STANDARD DRAWING APPROVED BY
[Signature]
30/11/10
DATE: _____ ASSISTANT EXECUTIVE DIRECTOR FOR INFRASTRUCTURE

MISCELLANEOUS BITUMINOUS PAVEMENT DETAILS
PLACING SEQUENCE OF BITUMINOUS COURSE TYPE 8

MBPD-14
MAY 2010