

**STEP 1: MILLING AND CLEANING THE SURFACE**

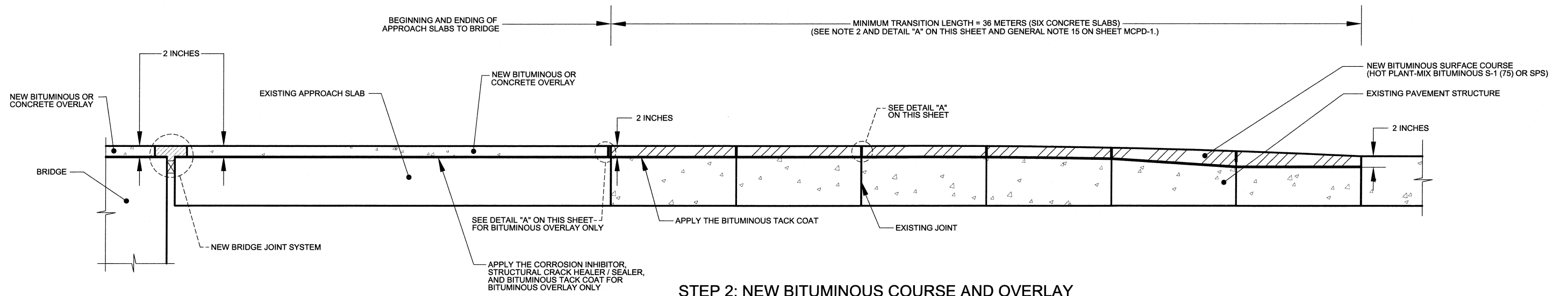

**STEP 2: NEW BITUMINOUS COURSE AND OVERLAY**

**NOTES:**

1. THE GENERAL NOTES, PROCEDURES AND DETAILS FOR TRANSITION TO CONCRETE PAVEMENTS AND STRUCTURES TYPE 3 ARE SHOWN ON SHEET MCPD-1.
2. THE NEW BITUMINOUS SURFACE COURSE SHALL BE CUT TO MAKE TRANSVERSE JOINTS OVER EXISTING OR NEW CONCRETE PAVEMENT JOINTS. THE NEW BITUMINOUS PAVEMENT JOINTS SHALL BE SEALED WITH HOT POURED JOINT SEALANT.

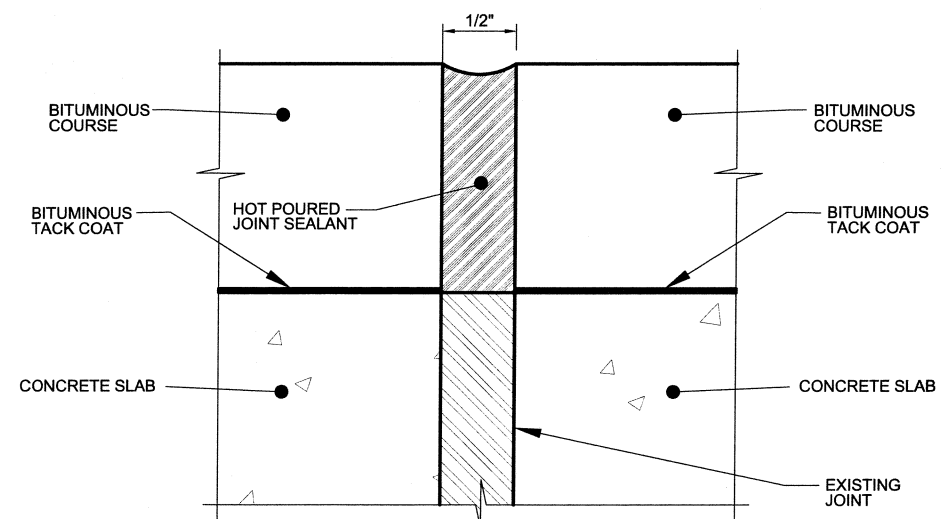

**DETAIL "A"**

DATE	REVISION	BY
SEP. 09	ORIGINAL	
MAY 10	NOTES	
DATE	REVISION	BY
DATE	REVISION	BY



COMMONWEALTH OF PUERTO RICO  
DEPARTMENT OF TRANSPORTATION AND PUBLIC WORKS  
HIGHWAY AND TRANSPORTATION AUTHORITY

STANDARD DRAWING APPROVED BY:  
*[Signature]*  
35/10/10  
ASSISTANT EXECUTIVE DIRECTOR  
FOR INFRASTRUCTURE

MISCELLANEOUS CONCRETE  
PAVEMENT DETAILS  
DETAILS FOR TRANSITION TO CONCRETE  
PAVEMENTS AND STRUCTURES TYPE 3

MCPD-04  
MAY 2010