

DWG BY: LMARTINEZ 2934

BY	REVISION	DATE
BY	REVISION	DATE
BY	REVISION	DATE
BY	REVISION	DATE
DATE	REVISION ORIGINAL NOTES	
SEP. 09		
MAY 10		

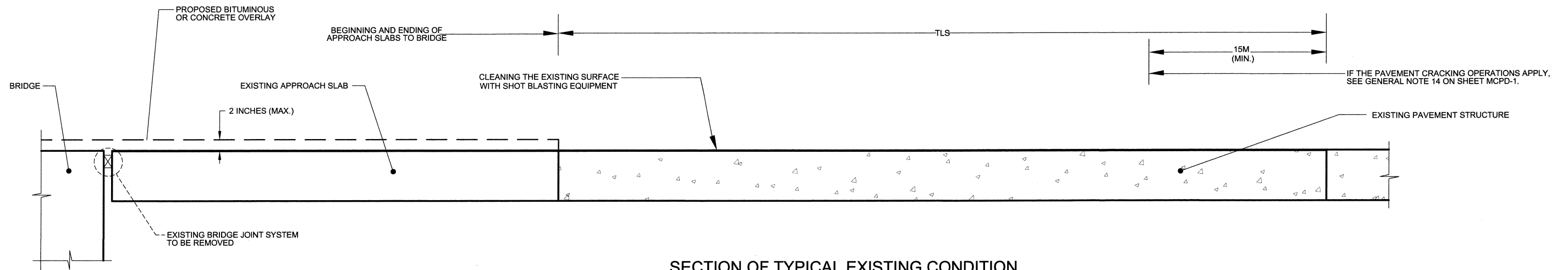

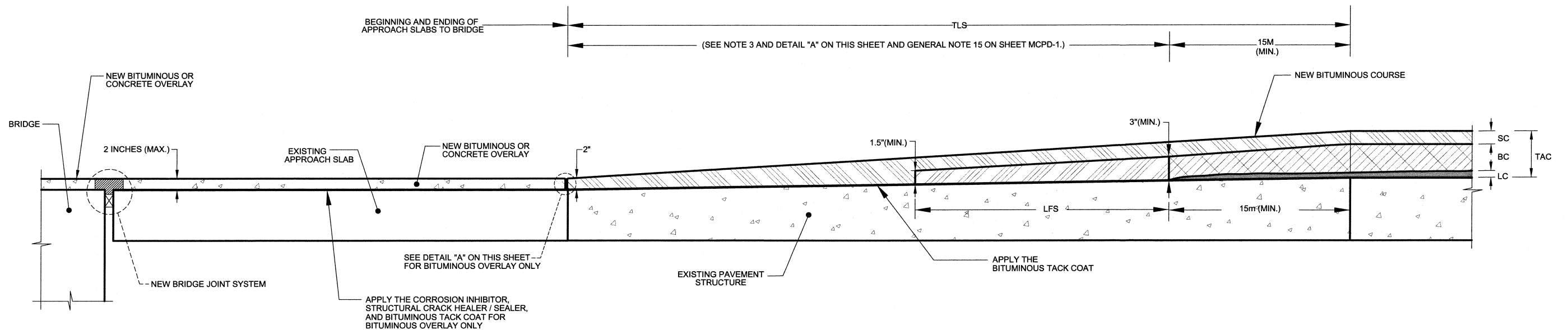



SECTION OF TYPICAL EXISTING CONDITION

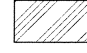

SECTION OF TYPICAL NEW BITUMINOUS COURSE AND OVERLAY

LEGEND

-  BITUMINOUS LEVELING COURSE (HOT PLANT-MIX BITUMINOUS L-2(75))
-  BITUMINOUS BASE COURSE (HOT PLANT-MIX BITUMINOUS B-1(75) OR SPB)
-  BITUMINOUS SURFACE COURSE (FIRST LAYER) (HOT PLANT-MIX BITUMINOUS S-1(75) OR SPS)
-  BITUMINOUS SURFACE COURSE (SECOND LAYER) (HOT PLANT-MIX BITUMINOUS S-1(75) OR SPS)

NOTES:

1. THE GENERAL NOTES, PROCEDURES AND DETAIL FOR TRANSITION TO CONCRETE PAVEMENTS AND STRUCTURES TYPE 6 ARE SHOWN ON SHEET MCPD-1.
2. THE PLACING SEQUENCES OF BITUMINOUS COURSES ARE SHOWN ON SHEET MCPD-10.
3. THE NEW BITUMINOUS SURFACE COURSE SHALL BE CUT TO MAKE TRANSVERSE JOINTS OVER EXISTING OR NEW CONCRETE PAVEMENT JOINTS. THE NEW BITUMINOUS PAVEMENT JOINTS SHALL BE SEALED WITH HOT POURED JOINT SEALANT.

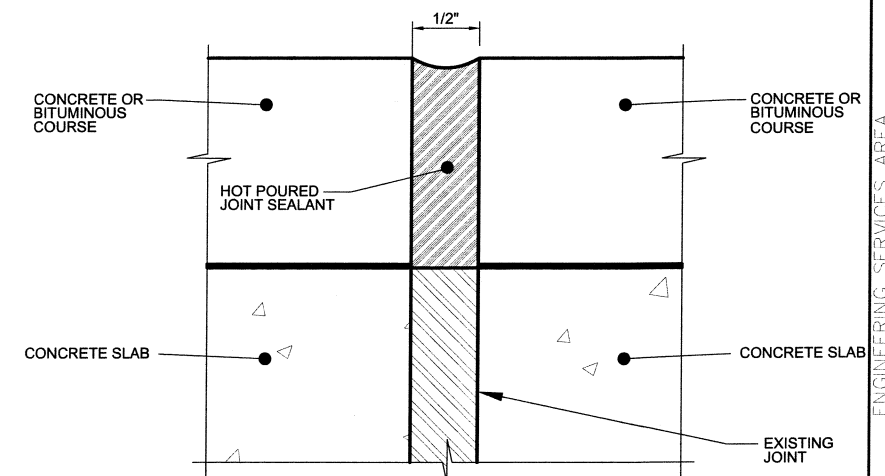

DETAIL "A"



COMMONWEALTH OF PUERTO RICO
DEPARTMENT OF TRANSPORTATION AND PUBLIC WORKS
HIGHWAY AND TRANSPORTATION AUTHORITY

STANDARD DRAWING APPROVED BY:

ASSISTANT EXECUTIVE DIRECTOR
FOR INFRASTRUCTURE

DATE:

30/10/18

MISCELLANEOUS CONCRETE
PAVEMENT DETAILS
DETAILS FOR TRANSITION TO CONCRETE
PAVEMENTS AND STRUCTURES TYPE 6

MCPD-09

MAY 2010

ENGINEERING STANDARDS OFFICE
ENGINEERING SERVICES AREA