

STEP 1: CLEANING THE SURFACE

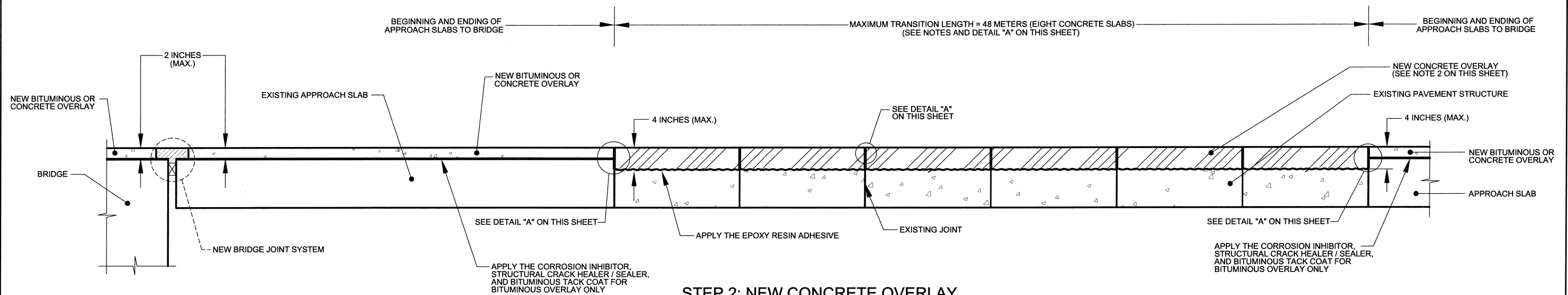

STEP 2: NEW CONCRETE OVERLAY

NOTES:

1. THE GENERAL NOTES, PROCEDURES AND DETAIL FOR TRANSITION TO CONCRETE PAVEMENTS AND STRUCTURES TYPE 8 ARE SHOWN ON SHEET MCPD-1.
2. THE NEW CONCRTE OVERLAY SHALL MEET THE APPLICABLE REQUIREMENTS OF THE PORTLAND CEMENT CONCRETE PAVEMENT (ACCELERATED STRENGTH), EXCEPT THE CONCRETE WILL BE PLAIN, AS PER STANDARD SPECIFICATION 503-"REMOVAL AND REPLACEMENT OF PORTLAND CEMENT CONCRETE PAVEMENT, FULL DEPTH".
3. THE EPOXY RESIN ADHESIVE SHALL MEET THE REQUIREMENTS OF THE STANDARD SPECIFICATION 503.
4. THE SEQUENCE OF PLACEMENT OF CONCRETE OVERLAY IN PAVEMENT SHALL BE ALTERNATE.

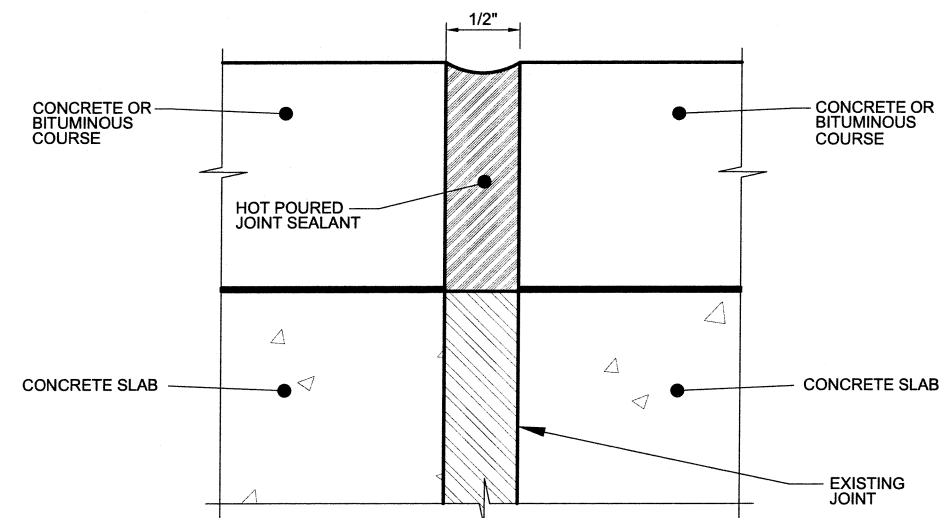

DETAIL "A"

DATE	REVISION	BY
SEP. 09 <td>ORIGINAL <td></td> </td>	ORIGINAL <td></td>	
MAY. 10 <td>NOTES</td> <td></td>	NOTES	