

DWG BY: LMARTINEZ 2934

| REVISION | DATE | BY |
|----------|------|----|
| | | |
| | | |
| | | |
| | | |
| | | |
| | | |
| | | |
| | | |
| | | |
| | | |
| | | |
| | | |
| | | |
| | | |
| | | |

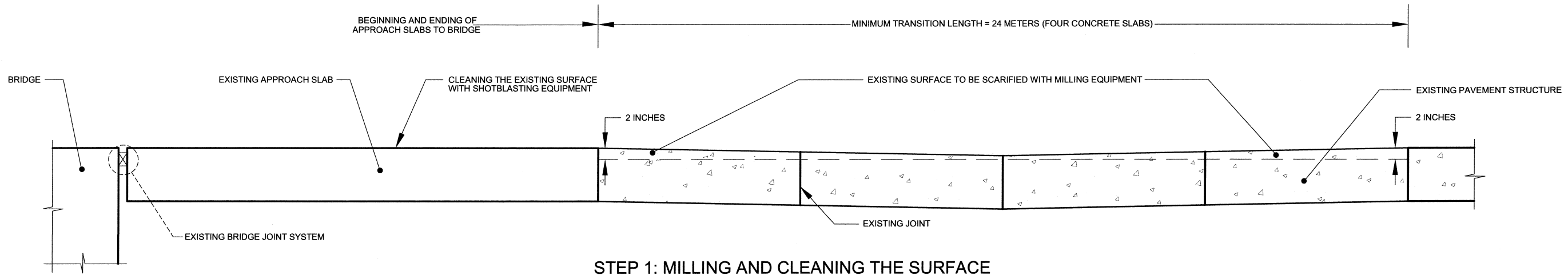

STEP 1: MILLING AND CLEANING THE SURFACE

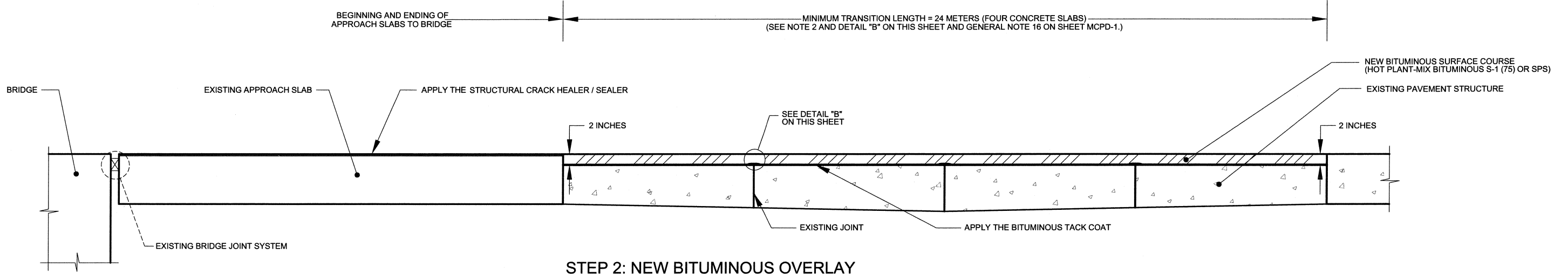

STEP 2: NEW BITUMINOUS OVERLAY

NOTES:

- 1. THE GENERAL NOTES, PROCEDURES AND DETAIL FOR TRANSITION TO CONCRETE PAVEMENTS AND STRUCTURES TYPE 9 ARE SHOWN ON SHEET MCPD-1.
- 2. THE STRESS-RELIEVING INTERLAYER MEMBRANE SHALL BE INSTALLED OVER PAVEMENT CRACKS, AND LONGITUDINAL AND TRANSVERSE JOINTS.

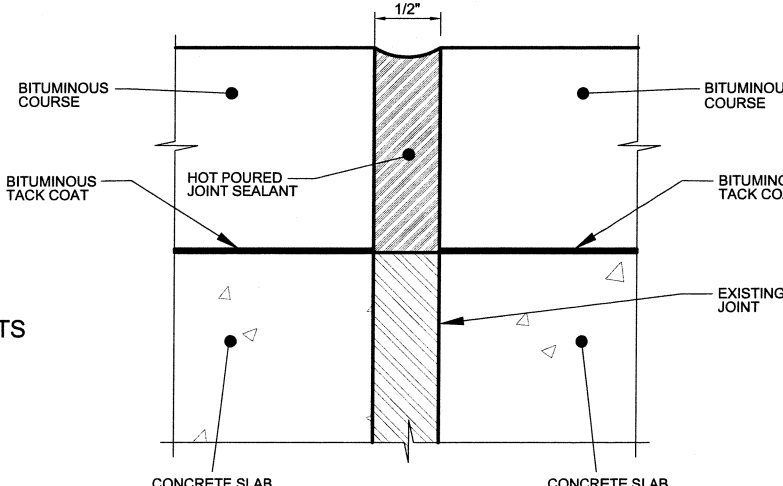

DETAIL "A"

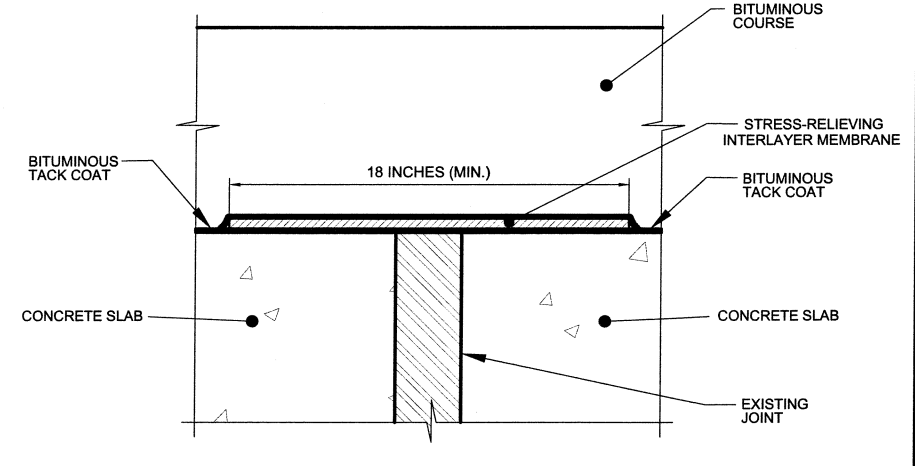

DETAIL "B"

| | | | | | |
|--|--|-------------------------------|--|--|----------|
| | COMMONWEALTH OF PUERTO RICO DEPARTMENT OF TRANSPORTATION AND PUBLIC WORKS HIGHWAY AND TRANSPORTATION AUTHORITY | STANDARD DRAWING APPROVED BY: | | MISCELLANEOUS CONCRETE PAVEMENT DETAILS | MCPD-13 |
| | | DATE: | | | |
| DETAILS FOR TRANSITION TO CONCRETE PAVEMENTS AND STRUCTURES TYPE 9 | | | | | MAY 2010 |

ENGINEERING STANDARDS OFFICE
ENGINEERING SERVICES AREA