

**LANE CLOSURE IN ADVANCE OF INTERSECTION**

**STOP SIGNS ON NORTH/SOUTH APPROACHES**

**NOTES:**

- 1 - DEPENDING ON TRAFFIC CONDITIONS, ADDITIONAL TRAFFIC CONTROL, SUCH AS FLAGGERS AND APPROPRIATE SIGNAGE, MAY BE NEEDED ON THE CROSS ROAD APPROACHES.
- 2 - FOR TWO-LANE, LOW-SPEED (35 MPH OR LESS) URBAN STREETS, A 200' SIGN SPACING SHALL BE USED.
- 3 - COST OF FLAGGER WILL BE A SUBSIDIARY OBLIGATION.

SPEED LIMIT	BUFFER (FT.)
35	200
45	350
55	400

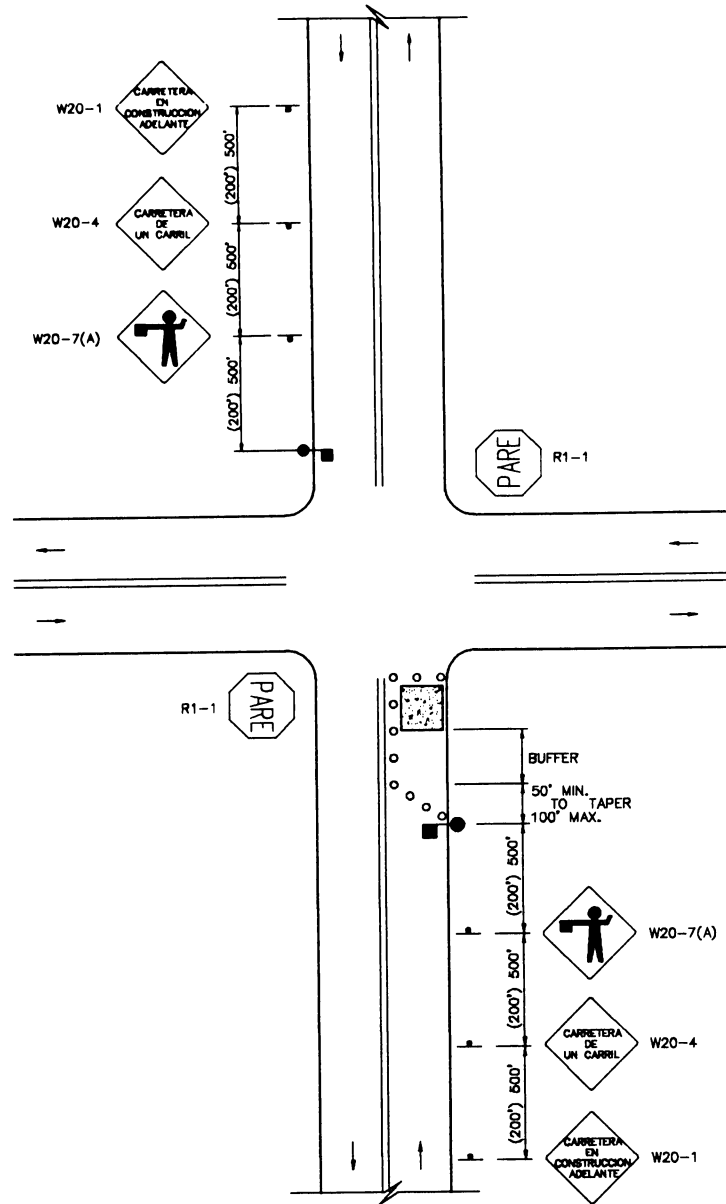

**LANE CLOSURE IN ADVANCE OF INTERSECTION**

**STOP SIGNS ON EAST/WEST APPROACHES**

**NOTES:**

- 1 - DEPENDING ON TRAFFIC CONDITIONS, ADDITIONAL TRAFFIC CONTROL, SUCH AS FLAGGERS AND APPROPRIATE SIGNAGE, MAY BE NEEDED ON THE CROSS ROAD APPROACHES.
- 2 - FOR TWO-LANE, LOW-SPEED (35 MPH OR LESS) URBAN STREETS, A 200' SIGN SPACING SHALL BE USED.
- 3 - COST OF FLAGGER WILL BE A SUBSIDIARY OBLIGATION.

**GENERAL NOTE:**

THE DESIGN OF SIGN PLATES SHALL BE IN ACCORDANCE WITH THE "MANUAL DE SEÑALES DE TRANSITO PARA LAS VIAS PUBLICAS DE PUERTO RICO" AND THE STANDARD DWGS. MPT 21 AND 22

EFFECTIVE DATE: APRIL 1996

COMMONWEALTH OF PUERTO RICO  
DEPARTMENT OF TRANSPORTATION  
AND PUBLIC WORKS  
HIGHWAY AND TRANSPORTATION AUTHORITY

**MAINTENANCE AND PROTECTION OF TRAFFIC  
TYPICAL APPLICATION DIAGRAMS**

RECOMMENDED BY: *[Signature]*  
DESIGN AREA DIRECTOR  
DATE: *May 9, 96*

APPROVED BY: *[Signature]*  
EXECUTIVE DIRECTOR  
DATE: *5/1/96*

APPROVED BY: *[Signature]*  
DIV. ADM. ENVA-PB DIVISION  
DATE: *5/1/96*

DATE	REVISION	BY

STD. MPT  
DWG. 18 OF 22